



SERVICED APARTMENTS & CONDOMINIUMS

[WWW.MEKONG-GARDENS.COM](http://WWW.MEKONG-GARDENS.COM)



Mekong Gardens, an ideal place for a short or long stay surrounded by nature and stunning views, situated along National Road 6A. The two high-rise buildings have 143 apartments providing tenants the privacy and comfort with gardens, full of flowers and a magnificent view of the Mekong River.

Many facilities are available for its tenants such as in house restaurant, swimming pool, children pool, BBQ area, gym, steam and sauna. Various car parking space and a 24/7 CCTV security system making your stay worry free and secure.

The apartment features a variety of single or double beds - all come with dining areas fully equipped kitchen and other home utilities. From the outside of the tiny yet comfortable balcony is the beautiful view of the Mekong River.

## Type B - Eucalyptus

2nd - 3rd Floor



Tower A

Tower B



ផ្ទៃក្រឡាសរុប | Total Area | 面积: 95.30m<sup>2</sup>

- បន្ទប់គេង ១ | 1 Bedroom | 1 卧室
- បន្ទប់ទឹក ១ | 1 Bathroom | 1 浴室
- បន្ទប់ទទួលភ្ញៀវ | Living Room | 客厅
- បន្ទប់ទទួលទានអាហារ | Dining Room | 饭厅
- ចង្រ្កានបាយ | Kitchen | 厨房
- កន្លែងបោកកក់ | Wash Area | 洗衣房

## Type E - Bougainvillea

5th - 10th Floor



Tower A



ផ្ទៃក្រឡាសរុប | Total Area | 面积: 70.42m<sup>2</sup>

- បន្ទប់គេង ១ | 1 Bedroom | 1 卧室
- បន្ទប់ទឹក ១ | 1 Bathroom | 1 浴室
- បន្ទប់ទទួលភ្ញៀវ និង រានបាល់ | Living Room & Balcony | 客厅与阳台
- បន្ទប់ទទួលទានអាហារ | Dining Room | 饭厅
- ចង្រ្កានបាយ | Kitchen | 厨房
- កន្លែងបោកកក់ | Wash Area | 洗衣房

## Type F - Lotus

5th - 10th Floor



Tower A

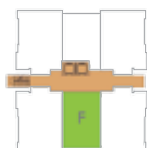

ផ្ទៃក្រឡាសរុប | Total Area | 面积: 79.33m<sup>2</sup>

- បន្ទប់គេង ១ | 1 Bedroom | 1 卧室
- បន្ទប់ទឹក ១ | 1 Bathroom | 1 浴室
- បន្ទប់ទទួលភ្ញៀវ និង រានហាល | Living Room & Balcony | 客厅与阳台
- បន្ទប់ទទួលទានអាហារ | Dining Room | 饭厅
- ចង្រ្កានបាយ | Kitchen | 厨房
- កន្លែងបោកគក់ | Wash Area | 洗衣房

## Type D - Rumdul

5th - 20th Floor



Tower A



ផ្ទៃក្រឡាសរុប | Total Area | 面积: 103.15m<sup>2</sup>

- បន្ទប់គេង ១ | 1 Bedroom | 1 卧室
- បន្ទប់ទឹក ១ | 1 Bathroom | 1 浴室
- បន្ទប់ទទួលភ្ញៀវ និង រានហាល | Living Room & Balcony | 客厅与阳台
- បន្ទប់ទទួលទានអាហារ | Dining Room | 饭厅
- ចង្រ្កានបាយ | Kitchen | 厨房
- កន្លែងបោកគក់ | Wash Area | 洗衣房

# • TWO BEDROOM

## Type C - Palm

3rd Floor

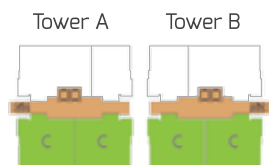

ផ្ទៃក្រឡាសរុប | Total Area | 面积: 124.61m<sup>2</sup>

- បន្ទប់គេង ២ | 2 Bedrooms | 2 卧室
- បន្ទប់ទឹក ២ | 2 Bathrooms | 2 浴室
- បន្ទប់ទទួលភ្ញៀវ | Living Room | 客厅
- បន្ទប់ទទួលទានអាហារ | Dining Room | 饭厅
- ចង្ហាន់បាយ | Kitchen | 厨房
- កន្លែងបោកគក់ | Wash Area | 洗衣房
- បន្ទប់អ្នកបំរើ | 1 Maid's Bedroom | 1 工人房

## Type H - Orchid

5th - 20th Floor

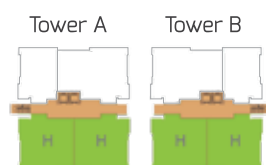

ផ្ទៃក្រឡាសរុប | Total Area | 面积: 143.03m<sup>2</sup>

- បន្ទប់គេង ២ | 2 Bedrooms | 2 卧室
- បន្ទប់ទឹក ២ | 2 Bathrooms | 2 浴室
- បន្ទប់ទទួលភ្ញៀវ និង រានហាល | Living Room & Balcony | 客厅与阳台
- បន្ទប់ទទួលទានអាហារ | Dining Room | 饭厅
- ចង្ហាន់បាយ | Kitchen | 厨房
- កន្លែងបោកគក់ | Wash Area | 洗衣房
- បន្ទប់អ្នកបំរើ | 1 Maid's Bedroom | 1 工人房

# THREE BEDROOM

## Type A - Jasmine

2nd - 3rd Floor



Tower A

Tower B



ផ្ទៃក្រឡាសរុប | Total Area | 面积: 165.48m<sup>2</sup>

- បន្ទប់គេង ៣ | 3 Bedrooms | 3 卧室
- បន្ទប់ទឹក ២ | 2 Bathrooms | 2 浴室
- បន្ទប់ទទួលភ្ញៀវ | Living Room | 客厅
- បន្ទប់ទទួលទានអាហារ | Dining Room | 饭厅
- ចង្រ្កានបាយ | Kitchen | 厨房
- កន្លែងបោកគក់ | Wash Area | 洗衣房
- បន្ទប់អ្នកបំរើ | 1 Maid's Bedroom | 1 工人房
- បន្ទប់ទឹកអ្នកបំរើ | 1 Maid's Bathroom | 1 工人浴室

## Type G - Ginkgo

5th - 20th Floor



Tower A

Tower B

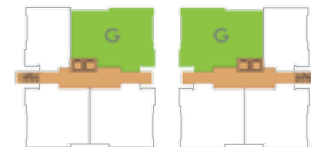

ផ្ទៃក្រឡាសរុប | Total Area | 面积: 173.94m<sup>2</sup>

- បន្ទប់គេង ៣ | 3 Bedrooms | 3 卧室
- បន្ទប់ទឹក ២ | 2 Bathrooms | 2 浴室
- បន្ទប់ទទួលភ្ញៀវ និង រោងបាយ | Living Room & Balcony | 客厅与阳台
- បន្ទប់ទទួលទានអាហារ | Dining Room | 饭厅
- ចង្រ្កានបាយ | Kitchen | 厨房
- កន្លែងបោកគក់ | Wash Area | 洗衣房
- បន្ទប់អ្នកបំរើ | 1 Maid's Bedroom | 1 工人房
- បន្ទប់ទឹកអ្នកបំរើ | 1 Maid's Bathroom | 1 工人浴室





## Facilities and Services

- Fully Fitted Kitchen
- Washing Machine
- Cleaning Service
- Laundry Service
- LCD TV with 65 Channels
- Wi-Fi Internet Access
- Complimentary Shuttle Service
- 24 hrs Electrical Back-up Power
- 24 hrs Reception, Security and Maintenance
- Fully Equipped Gym, Pool, Sauna and Steam.

## Location

Mekong Gardens is only a 10 minutes drive from Phnom Penh City Center, located in pleasant and relaxing surroundings and the beautiful Kien Khleing Pagoda. There are some local restaurants offering East meets West cuisine, good local facilities including banks, clinics and shopping malls.

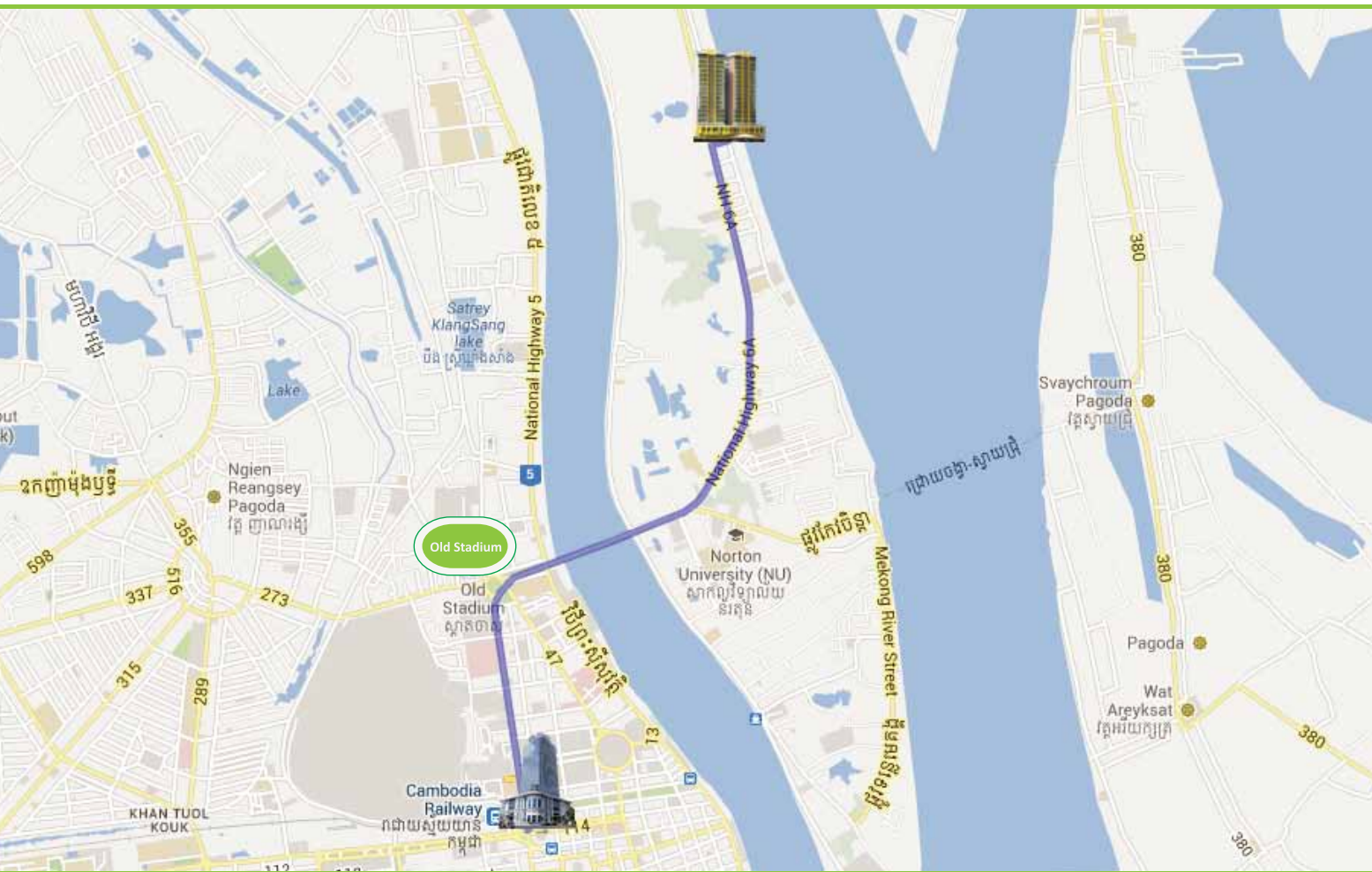

Tel: +855 (0) 23 69 59 635 • Fax: +855 (0) 23 95 02 18 • [info@mekong-gardens.com](mailto:info@mekong-gardens.com)  
National Road 6A, Chroy Changvar, Russey Keo, Phnom Penh, Kingdom of Cambodia



## FULLY FURNISHED APARTMENTS

No. of Unit: 143

No. of Floor: 20

Studio: 50 - 73 sqm

2Bedroom: 86 - 101 sqm

3Bedroom: 106 - 122 sqm



**REFRESHING BREEZE**



**QUIET & PEACEFUL LOCATION**



**NATURAL ENVIRONMENT**

